

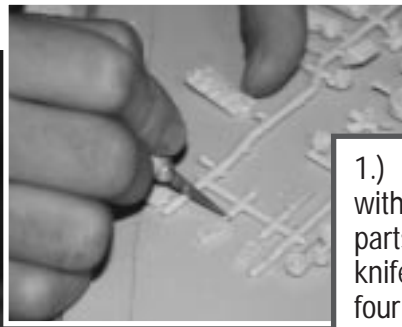

## Plastic Surgery 101

For most modelers, lowering a model comes as easy as tying their shoes. But to a beginner, this may be a big problem just getting a certain model to sit in that infamous lowered stance on the table. So in this section we chose to give the beginner modelers or Juniors a quick & easy way to lower a '64 Impala. By using existing kit parts, the '64 Impala poses no challenge for a beginner or novice in achieving the lowered effect. With its unique chassis design, **AMT/ERTL's** '64 Chevrolet Impala has become well-known as pretty much one of the easiest kits to lower. And really, there's no long list of supplies needed for a task this small, just an X-acto knife & blade, some glue (preferably super glue 'cause it dries fast) & a set of aftermarket wheels of your choice. So let's get bizzy!



1.) Cut the pin braces (part with two holes in it) off the parts tree using your X-acto knife. Make sure there are four because you will need one for each wheel opening.



2.) Take your X-acto knife & carefully trim off any excess plastic or mold flash around the area where the pin brace will fit. This should be done on all wheel openings.

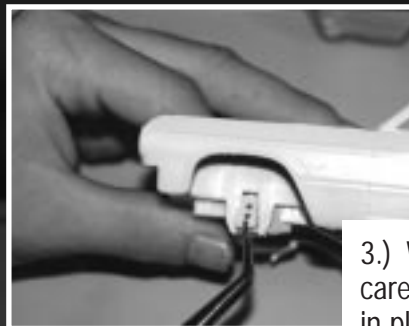

3.) With a set of tweezers, carefully glue the pin braces in place. Again, repeat this step on each area for every wheel. Once dry, insert your axle rod through the **top** pin brace hole & mount your tires. **Presto!** Your ridin' a few scale inches **LOWER**.

